

PLAT OF SURVEY

LOCATION: 6001 Hidden Creek Court, Lyons, Wisconsin

LEGAL DESCRIPTION:

Lot 25 in HIDDEN CREEK, being a redivision of a part of Lot 1 and all of Lots 2 thru 8, inclusive, Block 1, "Map of Burke and Campbell's Village of Lyons", together with a part of the Northeast 1/4 of the Northwest 1/4 and a part of the Northwest 1/4 of the Northeast 1/4 of Section 10, Town 2 North, Range 18 East, in the Town of Lyons, Walworth County, Wisconsin.

September 4, 1998

Survey No. 90130

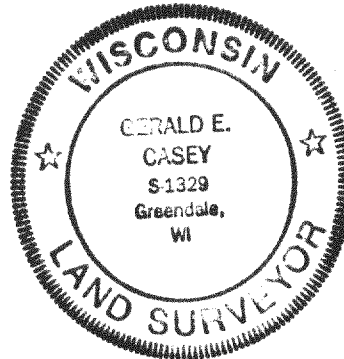

HIDDEN CREEK COURT

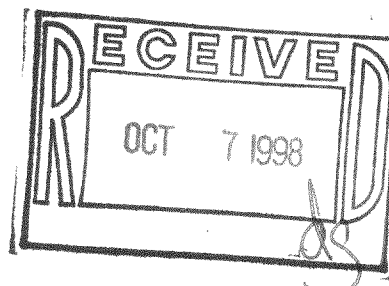

METROPOLITAN SURVEY SERVICE, INC.

REGISTERED LAND SURVEYORS

9415 W. FOREST HOME AVE., SUITE 202, HALES CORNERS, WI 53130

PH. 529-5380 FAX 529-9787

I HEREBY CERTIFY THAT I HAVE SURVEYED THE ABOVE DESCRIBED PROPERTY AND THAT THE ABOVE MAP IS A TRUE REPRESENTATION THEREOF AND SHOWS THE SIZE AND LOCATION OF THE PROPERTY, ITS EXTERIOR BOUNDARIES, THE LOCATION OF ALL VISIBLE STRUCTURES AND DIMENSIONS OF ALL PRINCIPAL BUILDINGS THEREON, BOUNDARY FENCES, APPARENT EASEMENTS AND ROADWAYS AND VISIBLE ENCROACHMENTS, IF ANY.

THIS SURVEY IS MADE FOR THE EXCLUSIVE USE OF THE PRESENT OWNERS OF THE PROPERTY, AND ALSO THOSE WHO PURCHASE, MORTGAGE, OR GUARANTEE THE TITLE THERETO WITHIN ONE (1) YEAR FROM DATE HEREOF.

SIGNED

Gerald E. Casey
Registered Land Surveyor S-1329

218-1020
NHC-25